

HKR Werkzeugtechnik

*Perfection in mold design and
construction*

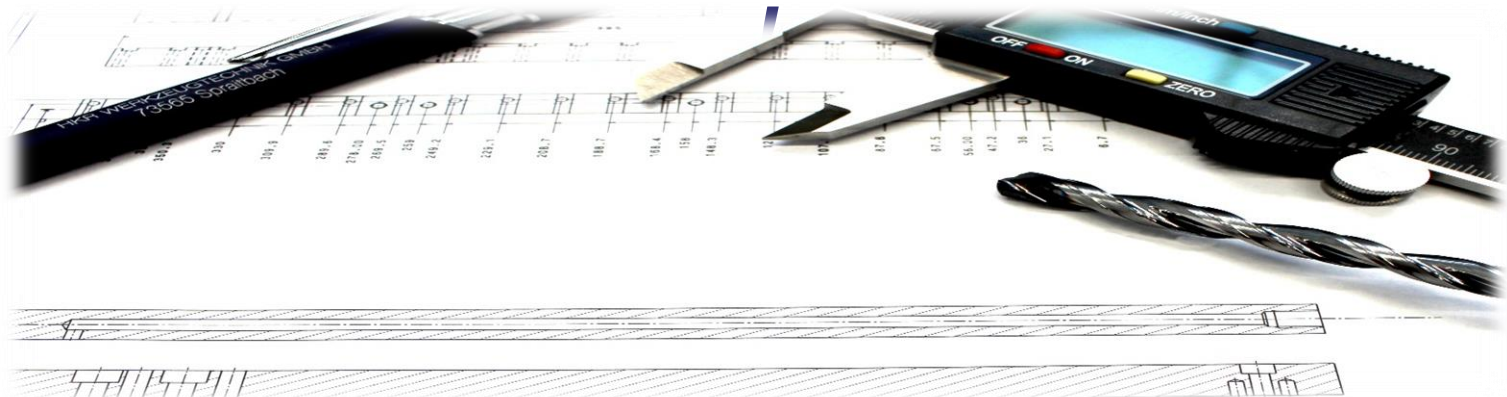

Company data

- Company foundation in 1994 by Wilhelm Hölldampf, Wilhelm König and Hans Rudolf
- Steady enlargement and expansion of the production capacity
- Ongoing investments in new technologies and production facilities
- Today's directors of the company are Mr. Hölldampf and Mr. Schürle

Company data

Headcount and sales volume

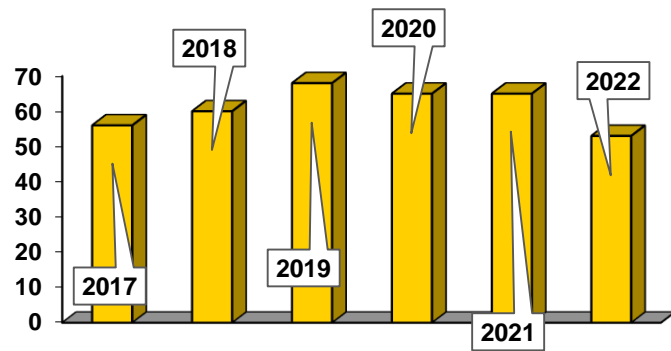

Employees

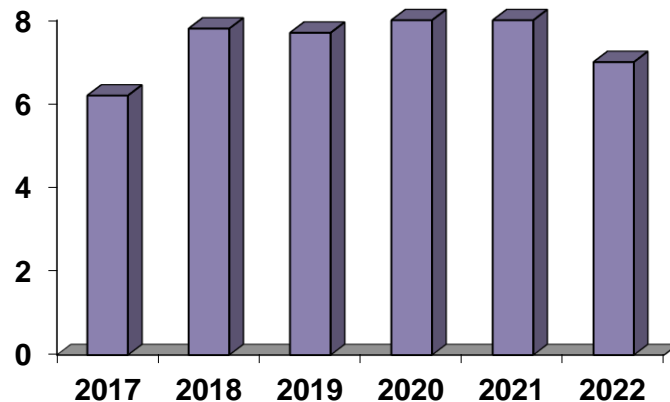

Turnover in Mio.

Business segments

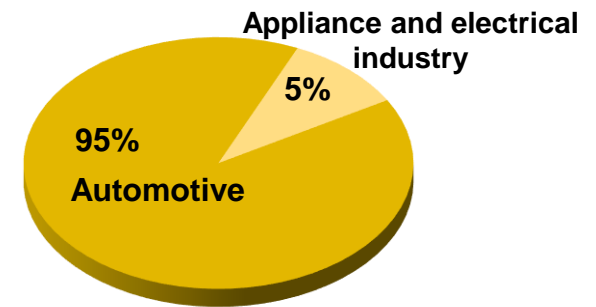

HKR – *ultimate toolmaking perfection*

- Expertise
- Reliability
- Quality
- Precision
- Adherence to schedules

 **Customer satisfaction**

Quality

In the interest of our clients we have high standards regarding the quality of our work.

Therefore we practice the quality assurance as a continuous and dynamic process which compromises the whole workflow from the development to the delivery.

Our business company is DIN-certified:
DIN EN ISO 9001:2015



ZDH-ZERT GMBH CERTIFIES THAT THE ORGANIZATION

HKR WERKZEUGTECHNIK GMBH
EUGEN-HAHN-STR. 35
73565 SPRAITBACH



IN THE SCOPE OF

DEVELOPMENT, DESIGN AND PRODUCTION OF INJECTION MOULDING TOOLS FOR VARIOUS TECHNOLOGIES AS WELL AS SAMPLE TRIALS, PILOT PRODUCTION AND PAID ADAPTATIONS

HAS INTRODUCED AND APPLIES A QUALITY MANAGEMENT SYSTEM IN ACCORDANCE WITH THE FOLLOWING STANDARD.

DIN EN ISO 9001:2015

THE RESPECTIVE VERIFICATION WAS BROUGHT BY AN ASSESSMENT OF THIS ORGANIZATION.

CERTIFICATE VALID UNTIL 03.10.2026
END OF VALIDITY PREVIOUS CERTIFICATE: 03.10.2023
CERTIFICATE REGISTRATION NO.: QI 0205009
Bonn, 06.10.2023

Dipl.-Ing. Peter Löpp
Head of Certification Body



Range of production

- Injection molds
- Injection stamping tools
- GID-molds
- Stack-tools
- Multi-component molds
- Fabric and - foil back injection molds
- Execution as prototype-, pre series and mass production molds
- Max. mold weight: **20 tons**

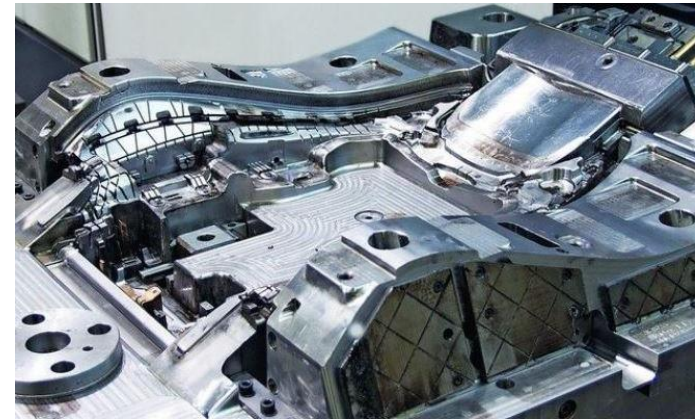

Contract production

- deep hole drilling
- spark erosive processing
- electrode production
- milling
- component development
- feasibility study
- mold repairs
- mold changes
- small batch and pre series



Data exchange

- Manifold data exchange to ensure a trouble-free process
- Further processing of the different data types
- On demand the customer receives the current information in every project phase on the basis of the latest CAD/CAM programs
- Data / gateway in all popular formats: Catia V5, Tebis 4.0 R7, Step, IGES, VDA-FS, NX

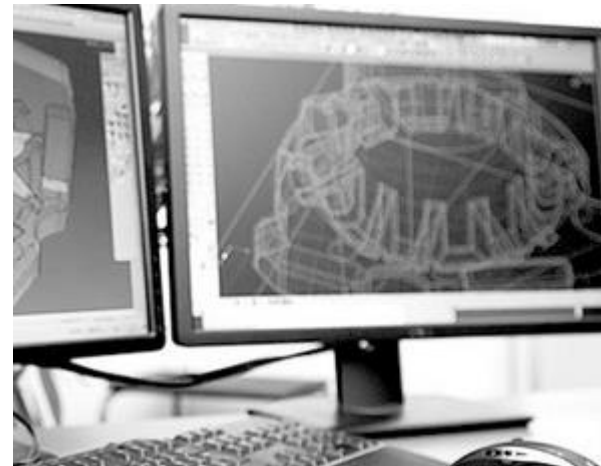

Your molds will be produced precisely on modern milling machines

Mecof Ecomill

Travel distance: 4000 x 1300 x 2500 mm



Mecof Umill 1800

Travel distance: 1800 x 2150 x 1250 mm



Production facility

2 x POSmill H800 U

Travel distance: 700 x 830 x 600 mm

Spindle speed: 18.000 U/min



POSmill C1050

Travel distance: 1.050 x 530 x 630 mm

Control: Heidenhain iTNC 530



POSmill E1100

Travel distance: 1100 x 600 x 510 mm
Spindle speed: ≤ 10.000 U/Min



Röders RP 800

Travel distance: 800 x 600 x 400 mm



Laser welding machine

Pulspower 200 CWS Speed Magnum

Working head with observation optics Leica Oculare 16*/14

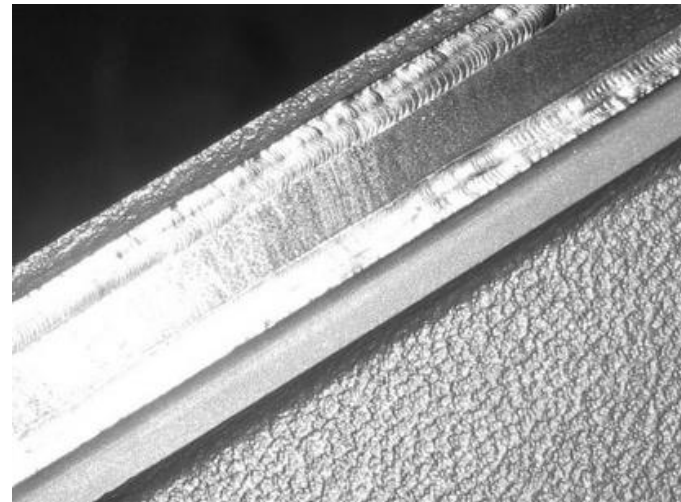

TBT

Gun drilling machine

Samag TFZ 2L-1000

Deep-hole drilling and milling machine
Travel distance: 1600 x 1250 x 1100 mm
Table load: 7000 Kg



Modern machinery in our EDM department:
4 EDM machines and 2 wire eroding machines

Ingersoll 1200

Travel distance: 1000 x 1500 x 650 mm

GF P900 (purchase 2019)

Travel distance: 900 x 700 x 500mm

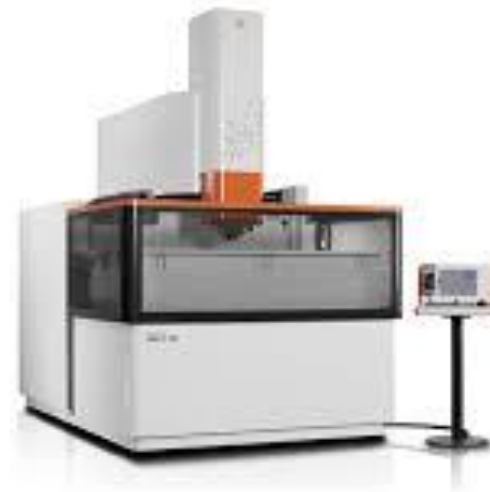

Production facility

Sodick AQ 55L

Travel distance : 550 x 400 x 350 mm

Sodick AQ 537L

Travel distance : 570 x 370 x 350 mm

Sodick AQ 535L

Travel distance: 650 x 350 x 350 mm

Zimmer + Kraim 600

Travel distance: 300 x 300 x 300 mm



Production facility

- Mold proving and try-outs on our own machinery
- Production of pilot series
- 5 Injection moulding machines with a clamping pressure between 80 and 1000 tons
- Drying facilities for materialdrying assured

DEMAG Ergotech 80-400

Injection molding machine
tie bar distance: H x V 400 x 400 mm

Battenfeld TM 2100-1000

Injection molding machine
tie bar distance: H x V 570 x 570 mm

Battenfeld TM 3500-1900

Injection molding machine
tie bar distance: H x V 710 x 710 mm



Krauss Maffei 1000 – 6100 MC

Injection molding machine
tie bar distance: H x V 1.400 x 1.120 mm
with robot handling

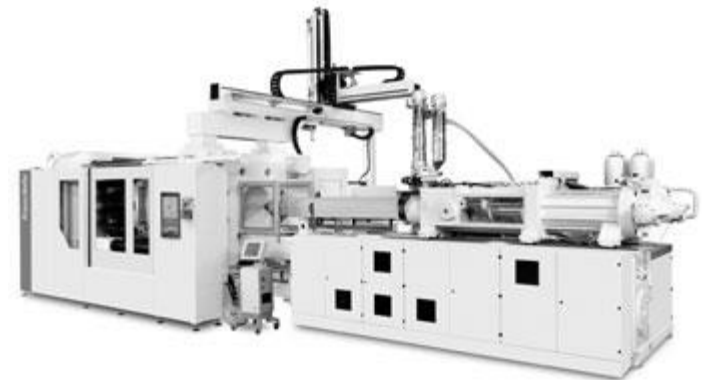

Krauss Maffei 650

Injection molding machine
tie bar distance: H x V 930 x 1000 mm
with robot handling



Purchasing of a Babyplast injection unit.

Therefore we are able to try out the following moulds:

- 2-Component- Index plate mold
- 2-Component - Sliding mold
- 2-Component – Blocking slide mold



with lateral aggregate supply on our machinery

Range of products

Quality parts are based on appropriate plastic constructions and precise manufactured molds.

With our molds we can promise you the sureness of a high-quality production regarding the cycle time.

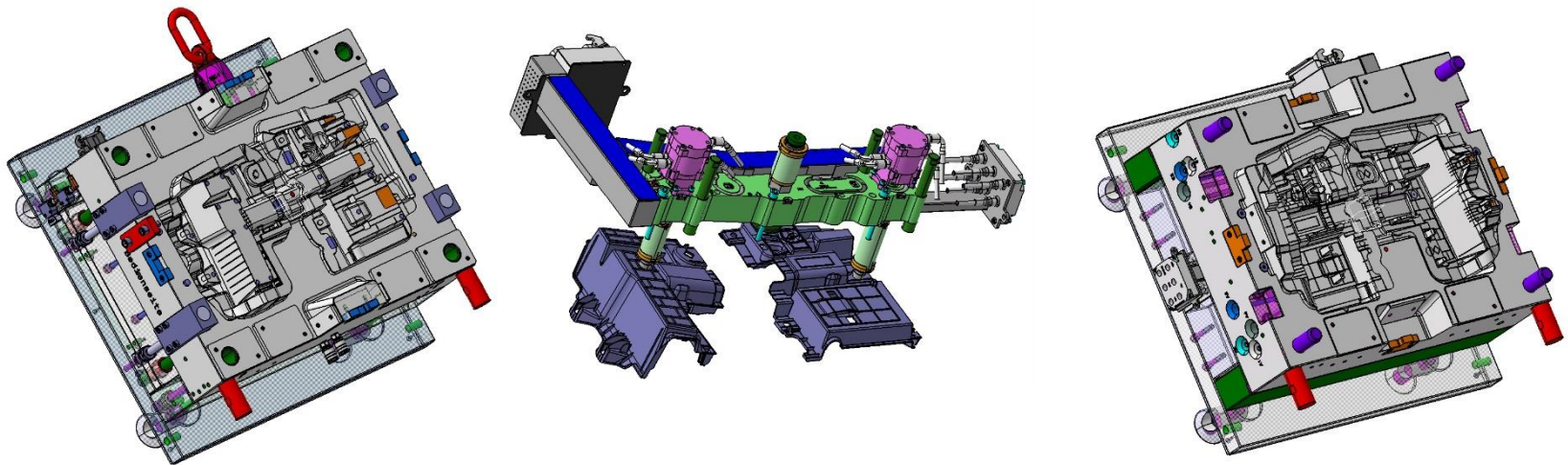

Range of products

Examples automotive: Mold (functionholder)



Examples automotive:

fabric back injection mold (A-pillar) incl. trimming (cutting)



B-pillar



Range of products

Examples automotive: Mold panel C-pillar



Mold side panel trunk incl. rollout



Range of products

Examples automotive: Mold (Airbag housing)

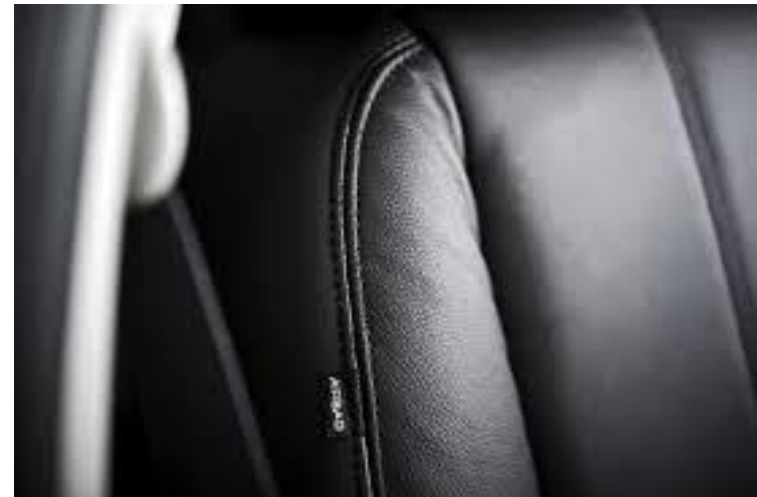

Examples automotive:

Mold (center console, deposition box and covers)



Range of products

Examples automotive: Mold (seat cover)

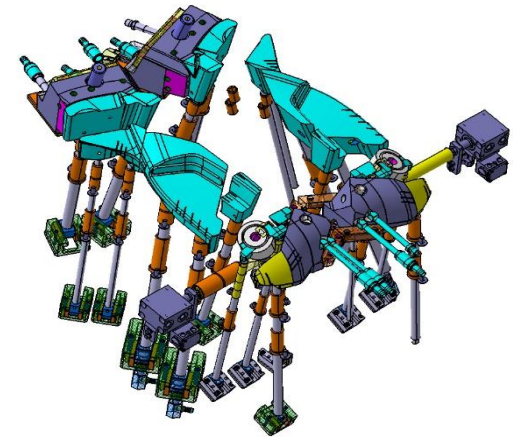
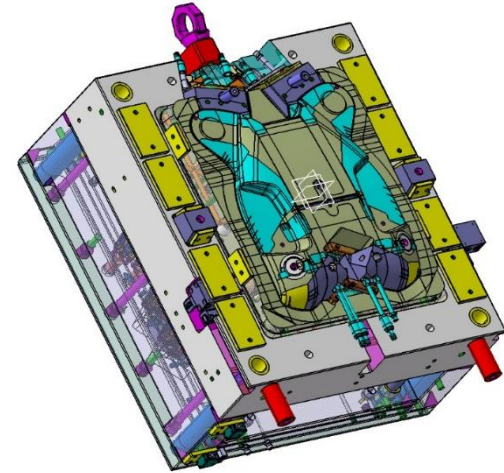

Range of products

Examples automotive:

2-Component-mold (tank recess)

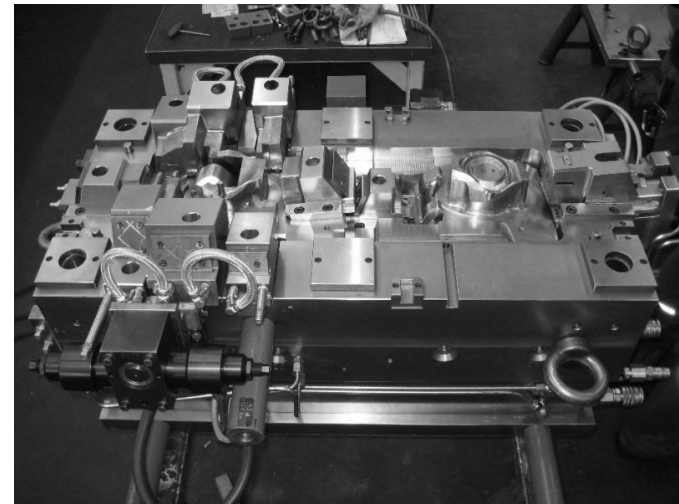

Range of products

Examples automotive: 2-Component- Index plate mold

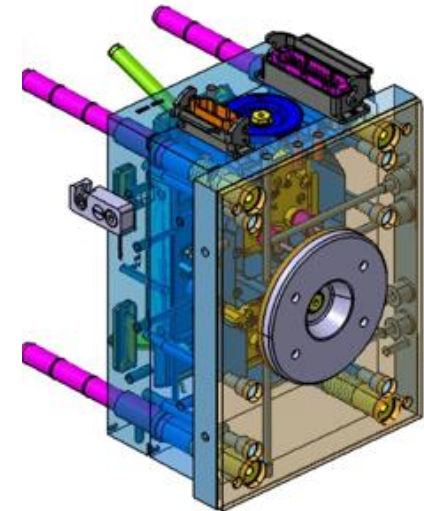
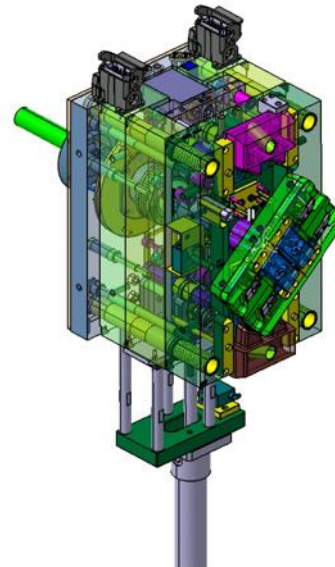

Range of products

Examples electrical industry: 2-Component-mold (Percussion drill)



Range of products

Examples automotive: Mold (Legroom coverage)



References



Contact persons:

- **Accountancy**
Mrs. Gabriele Novak
Phone: 07176 90001 -0
Email: buchhaltung@hkr-werkzeugtechnik.de
- **Data exchange**
Mrs. Julia Dittrich
Phone.: 07176 90001 -24
Email: j.dittrich@hkr-werkzeugtechnik.de
- **Purchasing Department**
Mr. Alexander Ziegler
Phone: 07176 90001 -14
Email: a.ziegler@hkr-werkzeugtechnik.de
- **Projectmanagement/ Sales**
Hr. M. Bulling/ Hr. M. Dorsch
Phone: 07176 90001 -28/ -15
Email: m.bulling@hkr-werkzeugtechnik.de
Email: m.dorsch@hkr-werkzeugtechnik.de

